

JANOME BULLETIN

For CoverPro Models

Bias Tape Guide and Belt Loop Folder

This attachment can be used in two ways: as a "**Bias Tape Guide**" that can guide bias tape (single fold) and sew it on to knit fabric, and as a "**Belt Loop Folder**" that can make belt loops from fabric tape. This attachment is useful for creating various types of sewing work.

Stitch pattern:
Top cover stitch Wide 6 mm
Cover stitch Wide 6 mm
*CoverPro 900CPX:
Cover stitch Wide 5 mm



Part No. 202-464-008

Point 1 Bias Tape Guide

Attach the attachment to the 2 holes on the front right of the CoverPro Models with the attachment screws (standard accessories).

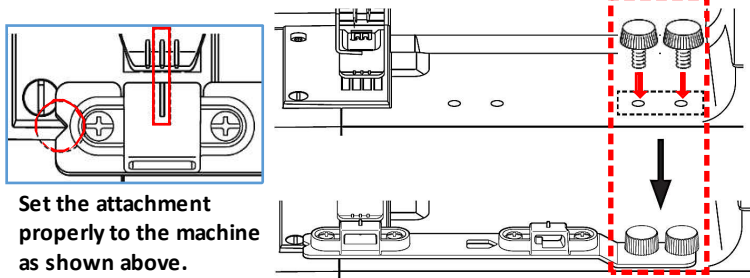

Point 1 Belt Loop Folder

Attach the attachment to the 2 holes on the front left of the CoverPro Models with the attachment screws (standard accessories).

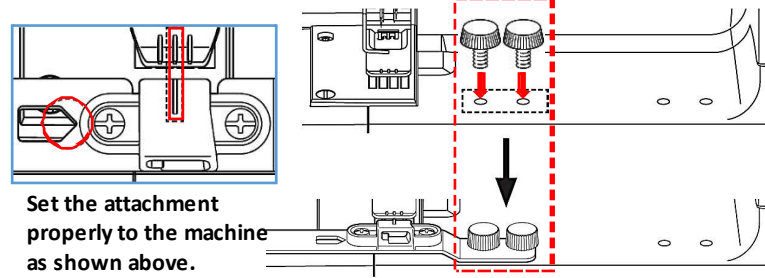

Point 2 Single fold 1/2" (12.7 mm) wide bias tape can be easily attached to knit fabric for decoration

Instead of bias tape, can also use ribbons of around the same width. Enjoy creating decorative knit works!

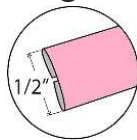
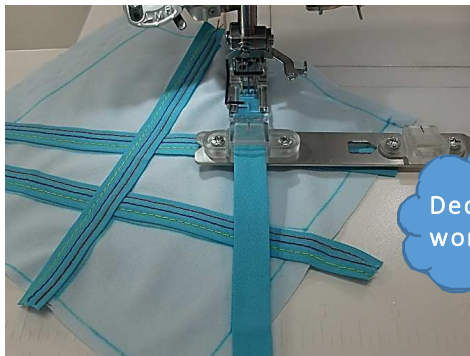

Decorate your work!



*It is easier to use with the Extra Wide Table #795812008 (Optional Item)

Point 2 7/16" (11 mm) wide belt loops can be easily made from 1" (25 mm) wide strips of fabric

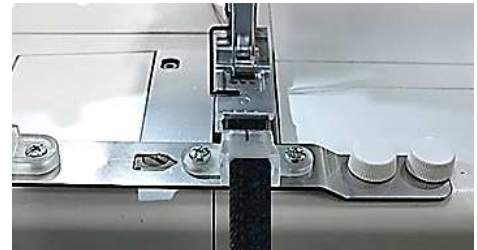

*Medium-heavy fabrics (10 oz denim or chino cloth, etc.) are recommended

After making a long belt loop, cut it to the appropriate length for each piece.

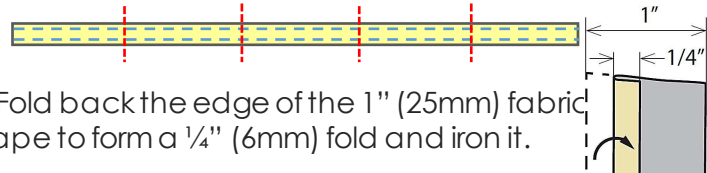

Tips How to adjust Bias Tape Guide on the CoverPro Models

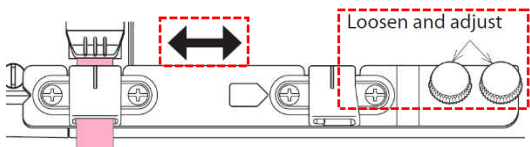

If the seam line seems out of alignment, adjust the Bias Tape Guide position by loosening the attachment screws.

Tips How to adjust Belt Loop Folder on the CoverPro Models

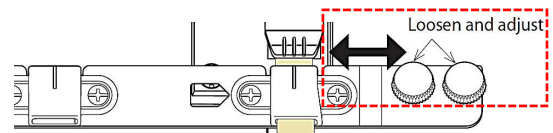

If the seam line seems out of alignment, adjust the Belt Loop Folder position by loosening the attachment screws.